

STEP 1: Complete the Test Requisition Form

Please fill out all sections of the Test Requisition Form

1 Patient Information

Required fields are highlighted in yellow

- Patient Name (Last Name/First Name/Middle Initial)
- Patient Social Security Number (SSN)
- Patient Gender
- Patient Date of Birth
- Patient Address
- Collection Date (date specimen was collected)
- Today's Date (date of service)

2 Physician Information

Complete prescribing physician contact information (physician name, NPI #, practice name, address, phone/fax numbers).

3 Billing Information

- Complete insurance information (Name, Group #, Policy #)
- Attach copy of insurance card (front & back)

4 Clinical Information

Please check all ICD-10 codes that apply

- Primary ICD-10
- Secondary ICD-10
- Attached clinical notes, especially current medications list

5 Specimen Information & Medical Necessity

- Please check specimen type and specify quantity
- Physician MUST sign the Medical Necessity Statement

Note: 2 buccal swabs or 1 saliva sample MUST be submitted with each test requisition form for testing to be performed.

6 Submission Instructions

- Affix barcoded stickers to all sample tubes and additional forms (clinical notes/current medication list, insurance info, etc)

7 Informed Consent Physician Signature (Page 2 - Back)

- Physician MUST fill out his/her name and patient's name
- Physician MUST sign and date form

8 Informed Consent Patient Signature (Page 2 - Back)

- Patient indicates how he/she wants his/her sample and information used (check Yes or No box)
- Patient MUST print name and sign and date form

Page 1 - Front

Page 2 - Back



STEP 2: Sample Collection - Buccal Swab

⚠ Do NOT eat, drink, or brush teeth for 1 hour prior to specimen collection. Collection should be performed by trained personnel.



1
Print patient name and date of birth on the tube label using ball point pen or permanent marker.



2
Affix one barcode sticker from the test requisition form to unlabeled portion of each swab tube.



3
Patient should rinse mouth with water immediately before specimen collection.



4
Twist off and gently pull the cap to separate the swab from the clear plastic tube.

Do not touch the white swab head with your hands or fingers during process.

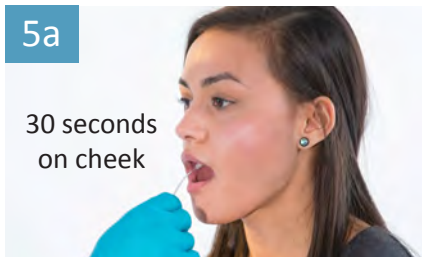

5a

30 seconds on cheek

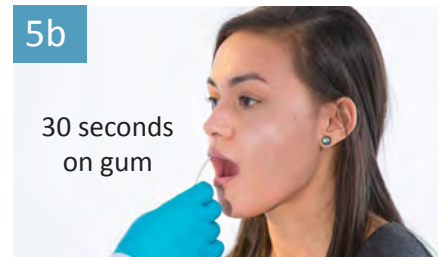

5b

30 seconds on gum

With sufficient pressure, rub and rotate the swab, sweeping across the cheek and gum, for a minimum of one minute.
30 seconds on cheek and 30 seconds on gum

Ensure entire swab head makes contact with patient's cheek and gum. Do not touch swab head against patient's teeth, lips, or any other surface.



6
Carefully reinsert the swab into the clear plastic tube, leaving it partially open to air dry swab for 5 minutes.



7

Once dry, press the cap firmly to secure.



8

Repeat Steps 1-7 using swab 2 on alternate side inner cheek and gum.

Swabs are intended for single use only. Store swabs at room temperature.

STEP 2: Sample Collection – Oral Rinse



Do NOT eat, drink, or brush teeth for 30 minutes prior to specimen collection. Collection should be performed by trained personnel.



1
Print patient name and date of birth on the tube label using ball point pen or permanent marker. Apply one barcode label to the collection tube.



2
Fill the measuring cup near the top with mouthwash.



3
Pour ALL of the contents of the cup into your mouth and swish vigorously for at least 15 seconds.



4
Spit ALL of the mouthwash from your mouth into the collection tube.

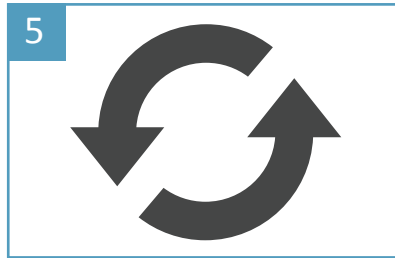

5
TWO COLLECTIONS REQUIRED!

Repeat steps 2, 3 and 4 adding to the same collection tube.



6
Confirm that the collection tube is filled at least to the 40ml line. Replace the cap on the collection tube and screw on tightly.



7
Place collection tube into the plastic bag provided for return shipment to laboratory.

NOTE: If you are not going to ship your sample immediately, store the collection tube in the refrigerator at 4° C.

DO NOT freeze.

STEP 2: Sample Collection - Saliva

⚠ Do NOT eat, drink, smoke, or chew gum for 30 minutes before collecting your saliva sample.

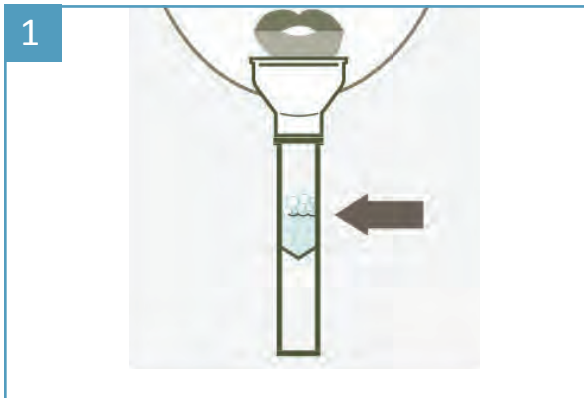

Fill the tube with saliva to the black wavy line.

Fill the tube until your saliva (not including bubbles) is at or just above the wavy line. Do not overfill. If you notice an excess in bubbles, eliminate them by gently tapping the tube on a hard surface.

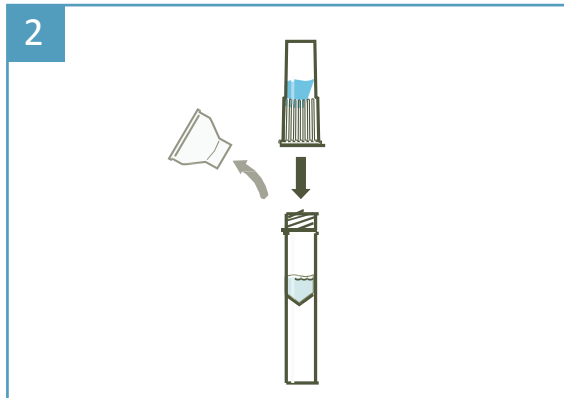

Replace the funnel with the cap.

Remove the funnel from the tube. Screw on the enclosed cap tightly to release the solution that will stabilize the DNA in your saliva.

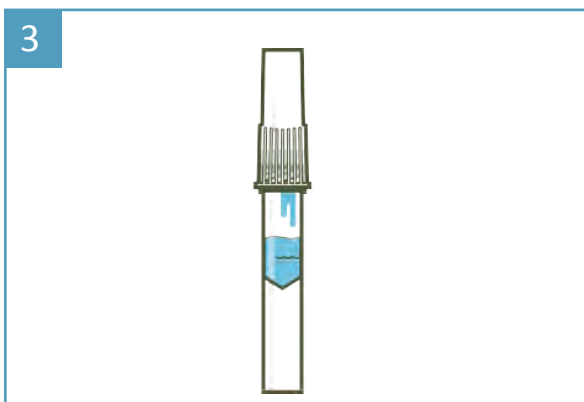

Tighten cap to release stabilizing solution.

Please make sure the blue solution from the cap has emptied into the tube.

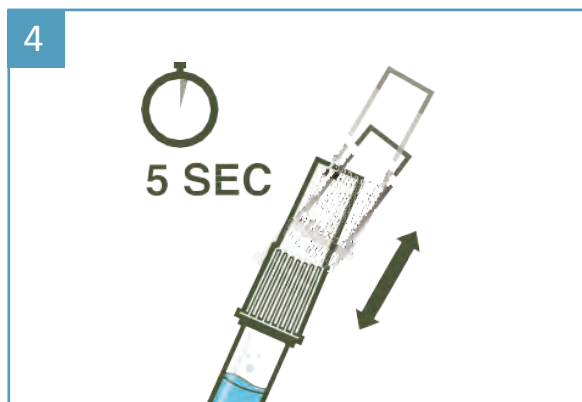

Shake the tube for at least five seconds.

Shaking tube thoroughly mixes saliva with the stabilizing solution to ensure high quality sample.

Cap choking hazard. Keep out of reach of children. Wash with water if stabilizing solution comes in contact with eyes or skin. Do not ingest solution.

Manufactured by Spectrum Solutions. This kit is designed for the collection of human saliva samples. Made in USA, Patent Pending.

STEP 3: Packaging and Shipping Instructions

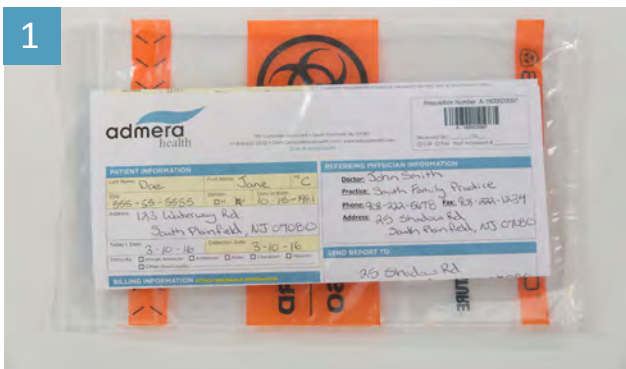

Insert the completed, signed test requisition form, signed informed consent, and supporting documents into the pouch on the outside of the biohazard bag.



Insert closed, labeled sample tubes (2 buccal swabs or 1 saliva sample) into the biohazard bag and seal.



Insert the biohazard bag into the pre-addressed FedEx clinical shipping package.



Arrange FedEx pickup or bring to FedEx drop box or facility for shipping to Admera Health.

The completed test requisition, signed informed consent, and labeled sample tubes must be submitted for testing. Missing information will result in delays.